

SKIRT SEALING SYSTEM

SPILL BLOCK MODEL : CSB-200

CARESS BELT CONVEYORS
Spill Block with CONCARE Skirt Sealing



Specifications.

Segmented sturdy wear resistant Skirt rubber blocks. Size of the Block 200mm width x 200mm height x 25 mm thk. Dove-Tail design interlocking Skirt Blocks avoids spillage line. Self Locking for clamp plates. More wear equation with height adjustable skirt blocks. Sturdy back plate with guided fastening Arrangement. Twin bolted design avoids oscillation. Chain type inter lock clamping for effectiveness. Serrated teeth in clamp plates ensure soft but firm contact. Adjustment by hammer tapping without loosening Fasteners. Ease of replacement of worn out skirt blocks.

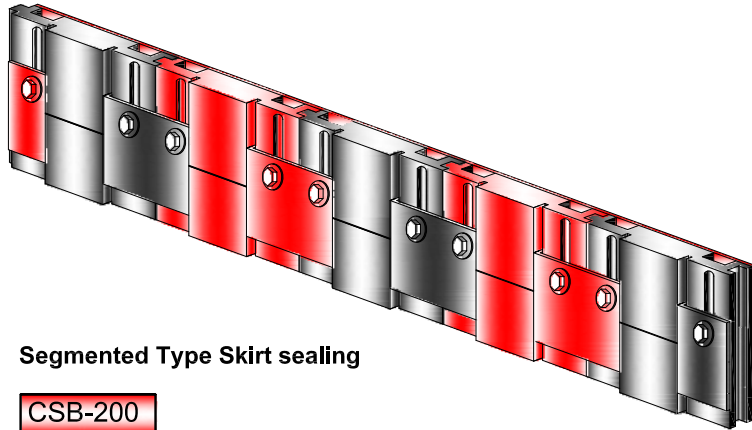

Segmented Type Skirt sealing

CSB-200

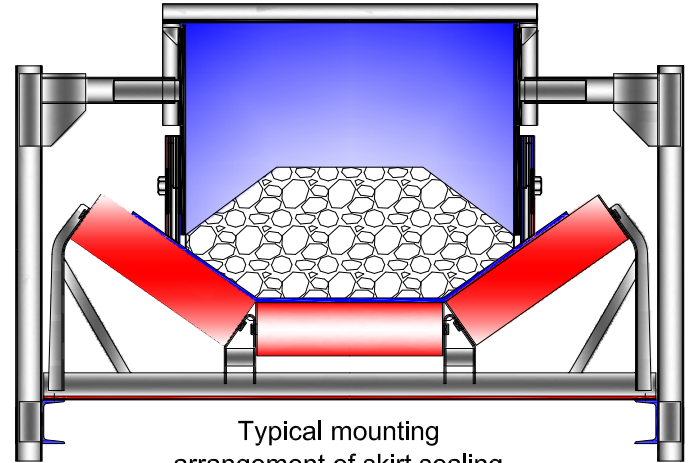

Typical mounting arrangement of skirt sealing

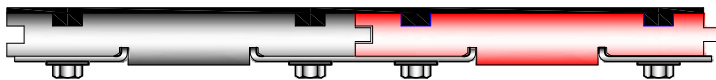

CSB-200

Length of Skirt Sealing system may be no. of 1000mm / 1200mm or multiple of 200mm.

Cost effective Simple to install & Easy to maintain.
Independent with Effective sealing efficiency.
Low space requirement and
Optimum skirt block wear life.
Suitable for all belt widths & speeds
Suitable to Uni & Bi Direction belts.

Increased conveyor operation efficiency.
Nil material wastages Results in good environment.
Longer belt life.

Normal Temperature Grade, Heat Resistance Grade and Oil Resistance Grade Skirt Blocks are available to suit application.

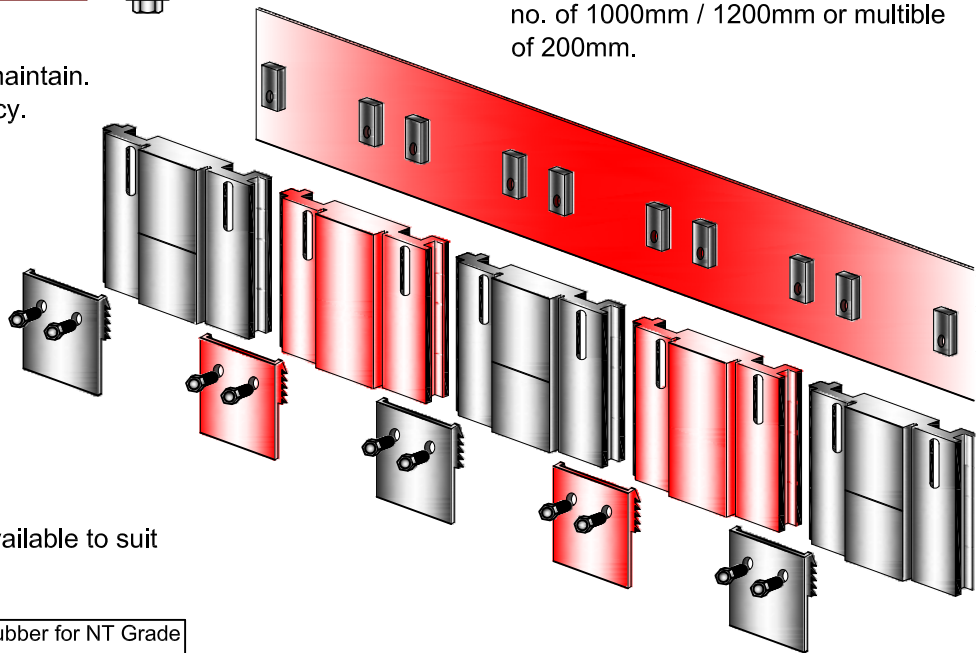

Material	Specification	Skirt Rubber for NT Grade
Hardness	IS 3400 PART-2 (1980)	55 to 65 Shore 'A' scale
Abrasion loss	DIN 53516	Maximum 100 mg.
Sp. Gravity	Standard	1.1 to 1.16 mg
Tensile Strength	IS 3400 PART-1 (1977)	180 kg/sq.cm. min.
Elongation at break	IS 3400 PART-1 (1977)	>350 %

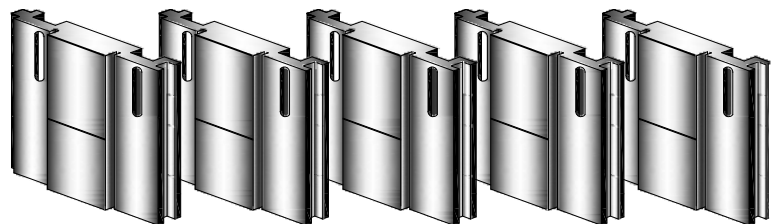

Head Office & Works

Caress Belt Conveyors by **BMH CONCARE TECHNOLOGY INC.**

A REVOLUTION IN ENVIRONMENTAL ENGINEERING

Plot no. 56, Sector-1, Service Industrial Area, Nerul (East), Navi Mumbai - 400 706 India.

Phone :- 022 27702626 / 3258 4616 / 09324297633 / 09324383067

Fax :- 022 27702625. E-Mail :- bmhsales@bmhconcare.com / bmhprojects@bmhconcare.com

BMH / CSB-200/011